

OKLAHOMA COUNTY
BOARD OF COUNTY COMMISSIONERS

AGENDA ITEM REQUEST SHEET

FOR THE August 18, 2010 AGENDA

(THE DEADLINE IS ONE WEEK PRIOR TO THE DATE THE AGENDA IS TO BE POSTED)

DEPARTMENT: District 3

REQUESTED BY: Ray Vaughn

REQUISITION NO: _____

REQUISITION SHEET ATTACHED: YES
_____ N/A

NAME OF FUNDS: _____

FUND NUMBERS: _____ / _____

PLEASE INITIAL IF PRIVACY/PROTECTED INFORMATION EXISTS: YES _____ N/A

NUMBER OF ORIGINAL DOCUMENTS TO BE RETURNED TO YOUR DEPARTMENT: _____

AGENDA ITEM READS AS FOLLOWS:

Discussion & possible action to grant or deny A.B.L.E. Commission application of Clauren Ridge LLC located at 6000 W. Waterloo Rd. in Oklahoma County District 3.

APPROVED BY DA
(If Applicable)

APPROVED BY ENGINEER
(If Applicable)

APPROVED BY PURCHASING
(If Applicable)

ASSISTANT DISTRICT ATTORNEY

COUNTY ENGINEER

PURCHASING AGENT

Please initial if privacy/security protected information exist

DISTRICT ATTORNEY -- PRIVACY/SECURITY PROTECTED INFORMATION: YES X N/A

COUNTY CLERK -- PRIVACY/PROTECTED INFORMATION: RC YES X N/A

(NOTE: THE CHAIRMAN/CHIEF DEPUTY MUST APPROVE ALL EMERGENCY REQUESTS FOR ANY ITEM SUBMITTED AFTER THE DEADLINE)

DATE OF REQUEST: _____ APPROVED BY: _____

CHAIRMAN

PENDING APPROVAL

August 13, 2010

Carla Jones
ABLE
4545 N. Lincoln Blvd., Suite 270
Oklahoma City, Oklahoma 73108

RE: Lauren Ridge Winery Zoning Compliance-Unincorporated Oklahoma County

Dear Ms. Jones:

This letter is regarding the request for zoning, health, fire, and safety code verification for the above referenced property, located at 6000 W. Waterloo Rd.

The property owner, Thomas Ingmire, applied for and received a Special Use Permit #SUP-2008-01 to operate the winery and vineyard. Oklahoma County does not require inspections for health, fire and safety codes. Other entities may require inspections.

If you have any questions, please contact Tyler Gammon @ (405) 713-1388 or Ruth Walters at (405) 713-1357.

Sincerely,

Stacey Trumbo, PE
County Engineer

PENDING APPROVAL

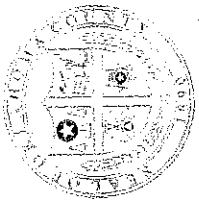

OKLAHOMA COUNTY PLANNING COMMISSION

320 Robert S. Kerr, Suite 101 • Oklahoma City, Oklahoma 73102-3431 • (405) 713-1361

August 11, 2010

Chairman: Ray L. Vaughn Jr.
Board of County Commissioners

State of Oklahoma
Alcohol Beverage Laws Enforcement Commission

Re: Oklahoma Winemaker Application No. 559277

To Whom It May Concern:

Clauren Ridge, LLC (Thomas Ingmire) has met all zoning and development requirements of our regulations and specifications. The application (SUP-2008-01) was reviewed, discussed and approved in public meetings on June 19, 2008 (Planning Commission) and July 9, 2008 (BOCC). BOCC Resolution #184-08 approved temporary zoning for 5 years or less. The Planning Commission recommends that the winemaker application be approved.

Sincerely,

A handwritten signature in black ink, appearing to read "Tyler Gammon".

Tyler Gammon
Planning Director

Enclosure

BOCC Resolution # 184-08

PENDING APPROVAL

OKLAHOMA COUNTY
BOARD OF COUNTY COMMISSIONERS

AGENDA ITEM REQUEST SHEET

FOR THE July 9, 2008 AGENDA

DEPARTMENT: Planning Commission REQUESTED BY: Tyler Gammon

REQUISITION NO.: N/A REQUISITION SHEET ATTACHED: YES N/A

NAME OF FUNDS: N/A

FUND NUMBERS: / /

DOES THE AGENDA ITEM CONTAIN PRIVACY-PROTECTED OR SECURITY INFORMATION? YES NO

AGENDA ITEMS CONTAINING PRIVACY-PROTECTED OR SECURITY INFORMATION WILL NOT BE HYPERLINKED TO THE AGENDA.

NUMBER OF ORIGINAL DOCUMENTS TO BE RETURNED TO YOUR DEPARTMENT: 0

AGENDA ITEM READS AS FOLLOWS: Discussion and Possible action to approve Resolution # _____ to amend a Zoning District of Oklahoma County. The Planning Commission held a public hearing on the 19th of June 2008 and approved the request of Thomas E. Ingmire for a Special Use Permit (SUP-2008-01) to develop Claren Ridge Vineyard and Winery with on-site fermentation, storage, bottling, and distribution functions as well as wine sales, consumption and special events on the premise. The Planning Commission recommends that the Board of County Commissioners approve the zoning change for a period of five (5) years or less if applicant desires to establish a permanent zoning change an earlier date. The property is located on 1.84 acres near NW 248th and N. May Ave. (County Highway District #3).

APPROVED BY DA
(if Applicable)



ASSISTANT DISTRICT ATTORNEY

APPROVED BY ENGINEER
(if Applicable)

COUNTY ENGINEER

APPROVED BY PURCHASING
(if Applicable)

PURCHASING AGENT

Please initial that document has been reviewed for privacy-protected or security information

DISTRICT ATTORNEY: YES N/A

COUNTY CLERK: YES N/A

Indicate any privacy-protected information that exists _____

(NOTE: THE CHAIRMAN/CHIEF DEPUTY MUST APPROVE ALL EMERGENCY REQUESTS FOR ANY ITEM SUBMITTED AFTER THE DEADLINE)

DATE OF REQUEST: June 23, 2008 APPROVED BY: _____ CHAIRMAN

PENDING APPROVAL

OKLAHOMA COUNTY PLANNING COMMISSION
 SPECIAL USE PERMIT (SUP-2008-01)
 PROPOSED USE: WINERY
 APPLICANT: THOMAS INGMIRE

--- WATERLOO ROAD ---

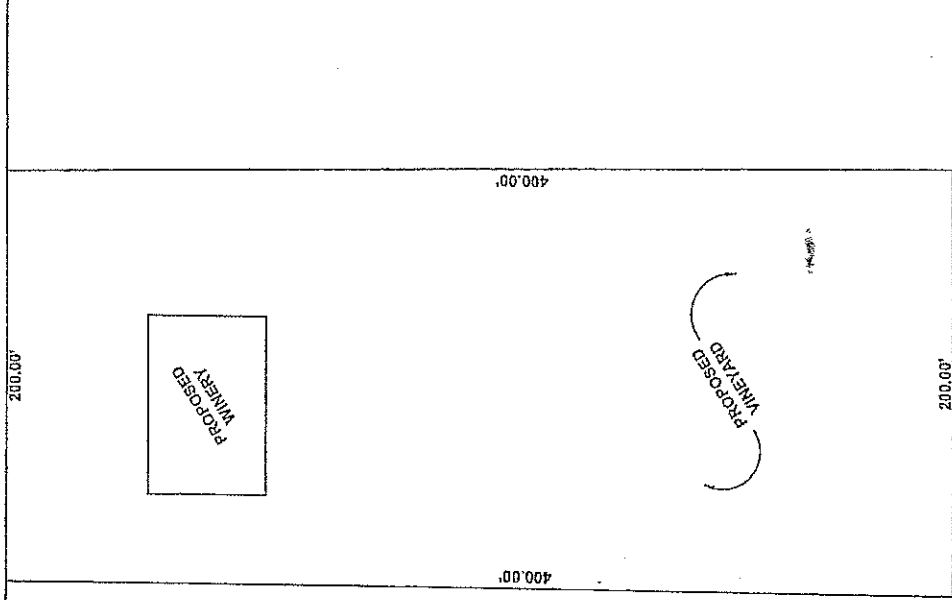

--- MAY AVENUE ---

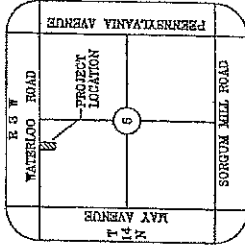

SECTION 6, T-14-N, R-9-W, 11M
 LOCATION MAP



**OKLAHOMA COUNTY
 ENGINEERING & PLANNING**

320 Robert S. Kerr, Suite 101
 Oklahoma City, Ok 73102-3431
 County Engineer : Stacey Trumbo, P.E.

Dates:	Scales:	Drawn By:
APRIL 2008	NO SCALE	GHM

PENDING APPROVAL

Map of 6000 W Waterloo Rd, Edmond, OK **YAHOO!**
73025-8618



PENDING APPROVAL

When using any driving directions or map, it's a good idea to do a reality check and make sure the road still exists, watch out for construction, and follow all traffic safety precautions. This is only to be used as an aid in planning.

A KEITH BURT
DIRECTOR AND
SECRETARY TO THE COMMISSION



BRAD HENRY
GOVERNOR

STATE OF OKLAHOMA
ALCOHOLIC BEVERAGE LAWS ENFORCEMENT COMMISSION

August 4, 2010

Board of County Commissioners
Oklahoma County
320 Robert S. Kerr, Suite 621
Oklahoma City, OK 73102

Re: Oklahoma Winemaker Application No. 559277

Dear Sir:

The Alcohol Beverage Laws Enforcement Commission is required by Title 37, Section 517 of the Oklahoma Statutes to notify you of that an application is being sought to sell alcohol, alcoholic beverages, wine or beer within your jurisdiction. Please make any recommendations on whether or not the applicant should be issued a license by the ABLE Commission within twenty (20) days after the date the copy of the application was mailed.

Thank you for your cooperation.

Sincerely,

A handwritten signature in cursive script that reads "Carla Jones".

Carla Jones
Licensing Division

lo

Enclosure

ABLE Form Lic-25 Revised 3/94

OKLAHOMA ALCOHOLIC BEVERAGE LAWS ENFORCEMENT COMMISSION APPLICATION

559277

The filing of this application does not commit the Commission to the granting of the license that you are applying for, nor does it permit you to operate the business named below before the granting of the license.

CLAUREN RIDGE VINEYARD AND WINERY

LICENSEE NAME CLAUEN RIDGE DOING BUSINESS AS NAME
PREMISE LOCATION THOMAS ENEMIRE 6000 W. WATERLOO RD. EDMOND, OKLAHOMA 73025

Check the type of application:

- Add-A-Partner
Airline/Railroad
Beer & Wine
Bonded Warehouse
Bottle Club
Brewer
Carrier
Caterer
Change of Corporate Officers
Change of Managers or Members
Class B Wholesaler
Distiller
Industrial
Mixed Beverage
NonResident Seller
Oklahoma Winemaker
Rectifier
Caterer/Mixed Beverage Combo
Retail Store
Sacramental Wine
Storage
Wholesaler
Winemaker

OATH

State of Oklahoma)
County of OKLAHOMA ss.

THOMAS ENEMIRE, being first duly sworn upon oath deposes and says: That he is the applicant who makes the above and foregoing application; that he has read and signed the same, knows the contents thereof and that all statements therein contained are true. Applicant(s) certifies that the statements and representations made herein are true and correct and consents that if any statements or representations herein are found to be false or omitted, that the Director may refuse to issue said license or may cause such license to be revoked forthwith at any time. He further agrees that he has filed all appropriate property with the County Assessor and that all ad valorem taxes assessed on his property, both real and personal, and wherever situated in the State of Oklahoma, have been paid.

Signature of Applicant(s)
Subscribed in my presence and sworn to before
of MAY, 20 10, before 3rd day
My commission expires: [Signature] Notary Public

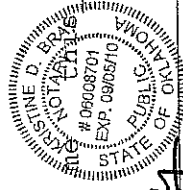

DO NOT WRITE IN THIS SECTION - CITY/COUNTY USE ONLY

In accordance with Title 37, Section 517, this notice is being mailed to you for recommendations as to whether or not this applicant should be issued a license in your city/county, by the ABLE Commission. You have twenty (20) days to respond. Please complete the following and submit a notarized copy of this page only to: ABLE COMMISSION, 4545 North Lincoln, Suite 270, Oklahoma City, OK 73105. (Attach additional page, if necessary.)

Grant Deny Reasons for denial

Signature of City/County Official

Title

Subscribed and sworn to before me this day of, 20

My commission expires: Notary Public

OKLAHOMA ALCOHOLIC BEVERAGE LAWS ENFORCEMENT COMMISSION

559277

1. Name(s) of Individual Applicant, Partners, Limited Partnership, Corporation, or Limited Liability Company (include social security number or federal employer identification number): EDMOND, [REDACTED]

1. THOMAS E. ENGMIRE (Address) 6000 W. WATERLOO RD. (City, State) OK. 73025 (zip) (SSN) [REDACTED]

2. Claren Ridge LLC

3. FET #

4.

2. Is License to be Issued to: Individual Partnership X
Corporation Limited Liability Company

3. Doing Business Name of Premises: CLAUREN RIDGE VINEYARDS AND WINERY

4. Premises Address: 6000 W. WATERLOO RD.
(Number, Street, Rural Route)

EDMOND, (OKLAHOMA) (City) OK. 73025 (State) (zip)

5. Business Mailing Address:
(If different than #4 above)

(P.O.Box, No., Street, R.R.)

(City) (State) (zip)

6. Was Premises Previously Licensed by the Commission: Yes X No

7. If Yes, to Whom? _____ Type of License: _____

8. Former Premises Name: _____

9. The Local Governing Body Where the Premises is Located: OKLAHOMA COUNTY
(Name of City or County)

10. Authorized Contact Person: THOMAS E. ENGMIRE

EDMOND,

6000 W. WATERLOO RD. (Address) OK. 73025 (Tel.No: Home/Business/Message) cell

SIGNATURE OF APPLICANT(S) 1. _____

(Individual, Partners, General Partner of a Limited Partnership, Authorized Corporate Officer, 2. Manager of a Limited Liability Company) 3. _____

4. _____

DATE

5/3/10

PENDING APPROVAL